

- HSU12C-TFW3B(INV)
- HSU12C-TKW3B(INV)
- HSU12C-TCR3B(INV)
- HSU18C-NMW3B(INV)
- HSU18C-NRW3B(INV)
- HSU18C-NSR3B(INV)
- HSU18C-NSB3B(INV)
- HSU18C-NSS3B(INV)
- HSU18S-NMW3B(INV)
- HSU18C-NMW4B(INV)
- HSU18C-NCB4B(INV)
- HSU18C-NDB4B(INV)
- HSU18C-NSS4B(INV)
- HSU18C-NCS4B(INV)
- HSU18C-NCG4B(INV)
- HSU18C-NPF4B(INV)
- HSU15C-TFW3B(INV)
- HSU12C-TFW5B1(INV)
- HSU12C-TDG5B(INV)
- HSU12C-TCG4B(INV)
- HSU18C-NPA4B(INV)
- HSU12C-TFW5B(INV)
- HSU12C-TRG3B(INV)
- HSU12C-TRS3B(INV)
- HSU12C-TCB3B(INV)
- HSU12C-TCS3B(INV)
- HSU18C-NRG3B(INV)
- HSU18C-NRS3B(INV)
- HSU18C-NCB3B(INV)
- HSU18C-NCS3B(INV)
- HSU18C-NPF3B(INV)
- HSU22C-TFW3B(INV)
- HSU19C-TFW5B(INV)
- HSU19C-TDG5B(INV)
- HSU19C-TDB5B(INV)
- HSU19C-TFW4B(INV)
- HSU19C-TDG6B(INV)
- HSU19C-TDS6B(INV)
- HSU12C-TDS6B(INV)
- HSU12C-TDG6B(INV)
- HSU12C-TFW4B(INV)
- HSU12C-TCB4B(INV)
- HSU18C-NPA3B(INV)

Parts and Functions

Indoor Unit

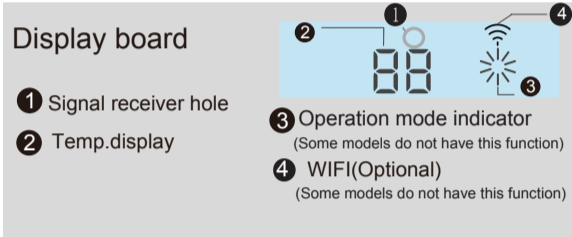
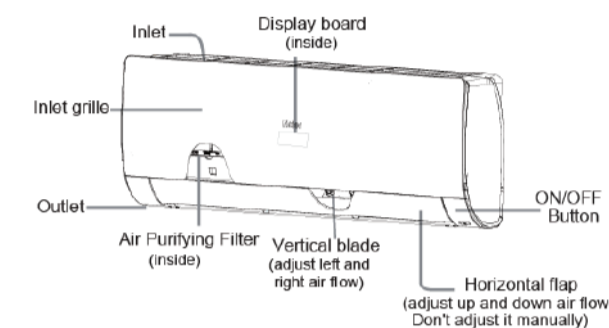

Outdoor Unit

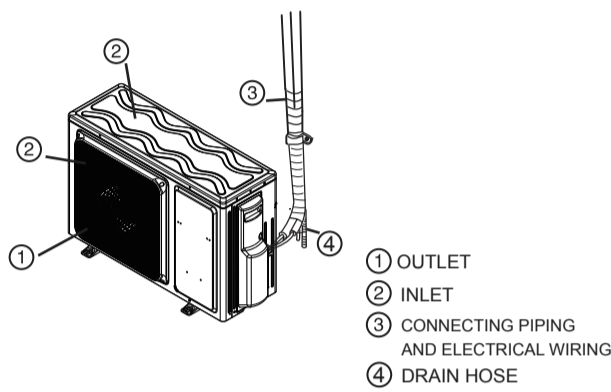

Actual inlet grille may vary from the one shown in the manual according to the product purchased

- Please read this operation manual before using the air conditioner. Keep this operation manual for future reference.

Operation

Emergency operation and test operation

Emergency Operation:

- Use this operation only when the remote controller is defective or lost, and with function of emergency running, air conditioner can run automatically for a while.
- When the emergency operation switch is pressed, the "Pi" sound is heard once, which means the start of this operation.
- When power switch is turning on for the first time and emergency operation starts, the unit will run automatically in the following modes:

Room temperature	Designated temperature	Timer mode	Fan speed	Operation mode
Above 23°C	26°C	No	AUTO	COOL



- It is impossible to change the settings of temp. and fan speed, it is also not possible to operate in timer or dry mode.

Test operation:

Test operation switch is the same as emergency switch.

- Use this switch in the test operation when the room temperature is below 16°C, do not use it in the normal operation.
- Continue to press the test operation switch for more than 5 seconds. After you hear the "Pi" sound twice, release your finger from the switch: the cooling operation starts with the air flow speed "Hi".
- Under this operation mode, the fan motor of indoor unit will run in high speed.



Air Flow Direction Adjustment

1. Status display of air flow

Vertical flap  
Pos.1 (Auto swing)

Pos.2 No initial state displayed on remote controller, the vertical flap will be fixed on the current position

2. Left and right air flow adjustment

(This function is unavailable on some models.)  
For each press of SWING button, remote controller displays as follows:  
remote controller:



Note: In some model: The remote has the button SWING. But the AC doesn't have the left and right air flow auto adjustment function. In this condition, change the direction of vertical blades manually.

Cautions:

- When adjusting the flap by hand, turn off the unit.
- When humidity is high, condensate water might occur at air outlet if all vertical louvers are adjusted to left or right.
- It is advisable not to keep horizontal flap at downward position for a long time in COOL or DRY mode, otherwise, condensate water might occur.

Note:  
When restart after remote turning off, the remote controller will automatically memorize the previous set swing position.

Sleep Operation

Before going to bed, you can simply press the SLEEP button and unit will operate in SLEEP mode and bring you a sound sleep.

Operation Mode

- In COOL, DRY mode  
1 hours after SLEEP mode starts, temp. will become 1°C higher than temp. setting. After another 1 hour, temp. rises by 1°C further. The unit will run for further 6 hours then stops. Temp. is higher than temp. setting so that room temperature won't be too low for your sleep.

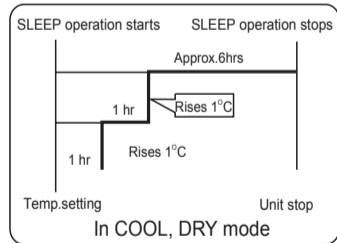

- In FAN mode: It has no SLEEP function.
- Set the wind speed change when sleeping  
If the wind speed is high or middle before setting for the sleep, set for lowering the wind speed after sleeping. If it is low wind, no change.

Note  
When TIMER function is set, the sleeping function can't be set up. After the sleeping function is set up, if user resets TIMER function, the sleeping function will be cancelled; the machine will be in the state of timing-on.

TURBO/QUIET Operation

When you need fast cool or fast dehumidification, you can choose the Turbo function; when you sleep, read, you can choose Quiet function

Press the TURBO button, you can switch the "Turbo" and "Quiet" function easily. Every press, the remote controller will switch as below

When running in Turbo, the fan speed is the highest, when running in Quiet, the fan speed is super slow

Remote controller

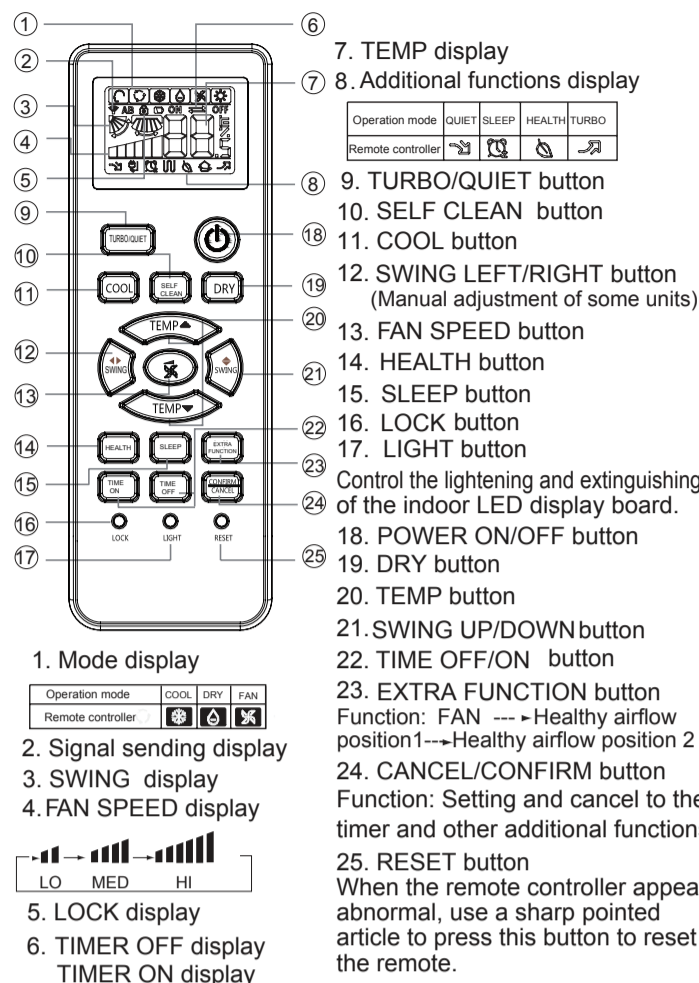

Healthy function is not available for some units.

Loading of the battery

- Remove the battery cover;
- Load the batteries as illustrated. 2 R-03 batteries, resetting key (cylinder);
- Be sure that the loading is in line with the "+" / "-";
- Load the battery, then put on the cover again.

- Note:
- The distance between the signal transmission head and the receiver hole should be within 7m without any obstacle as well.
  - When electronic-started type fluorescent lamp or change-over type fluorescent lamp or wireless telephone is installed in the room, the receiver is apt to be disturbed in receiving the signals, so the distance to the indoor unit should be shorter.
  - Full display or unclear display during operation indicates the batteries have been used up. Please change batteries.
  - If the remote controller can't run normally during operation, please remove the batteries and reload several minutes later.

Base Operation

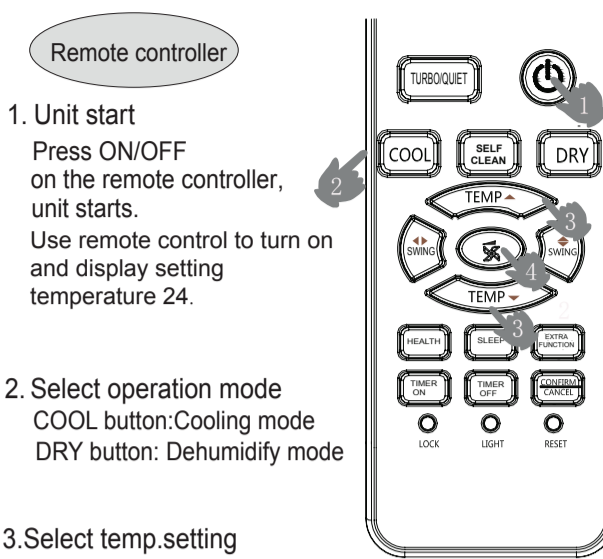

- Unit start  
Press ON/OFF on the remote controller, unit starts.  
Use remote control to turn on and display setting temperature 24.
- Select operation mode  
COOL button: Cooling mode  
DRY button: Dehumidify mode
- Select temp. setting  
Press TEMP▲ / TEMP▼ button  
TEMP▲ Every time the button is pressed, temp. setting increase 1°C, if kept depressed, it will increase rapidly  
TEMP▼ Every time the button is pressed, temp. setting decrease 1°C, if kept depressed, it will decrease rapidly  
Select a desired temperature.
- Fan speed selection  
Press EXTRA FUNCTION button to enter additional options, when cycle display to [X], [X] will flash. And then press [CANCEL] enter to FAN function.  
Press FAN button. For each press, fan speed changes as follows:  
Remote controller:

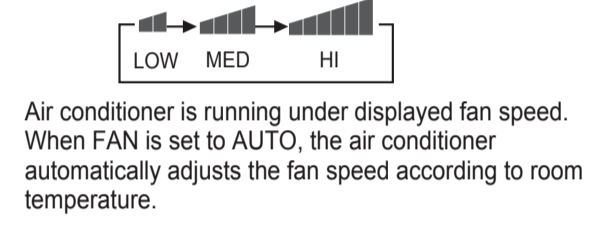

Operation Mode	Remote Controller	Note
COOL	[Snowflake icon]	according to room temperature.
DRY	[Water drop icon]	In DRY mode, when room temperature becomes lower than temp. setting + 2°C, unit will run intermittently at LOW speed regardless of FAN setting.
FAN	[Fan icon]	In FAN operation mode, the unit will not operate in COOL or HEAT mode but only in FAN mode. AUTO is not available in FAN mode. And temp. setting is disabled. In FAN mode, sleep operation is not available.

Operation

Dry Operation

Press "DRY" Button, when the LCD displays [Water drop icon], Dry Mode is set.  
In Dry mode, compressor will stop to operate when the room temperature is below the setting temperature. If the room temperature is higher than the setting temperature, the logic circuit will control the operation of compressor and indoor fan speed, in order to cause dew formation on cooling coil to obtain the effect of dehumidification. In dry mode, it is normal that the indoor fan speed is lower than other operation mode.

Timer On/Off On-Off Operation

- Set ON timer  
Press "ON" to activate the screen or block the emitter and press ON. Press "TIME ON", set the duration (hour). Press "CONFIRM/CANCEL".
- Set OFF timer  
Press "TIME OFF", set the duration.  
Press "CONFIRM/CANCEL".
- Set ON/OFF timer  
Press "ON" to activate the screen or block the emitter and press ON. Press "TIME ON" & set the duration. Press "CONFIRM/CANCEL".  
Press "TIME OFF" & set the duration  
Press "CONFIRM/CANCEL".  
The sequence of ON or OFF does not related to the setting sequence. But, it related to period set.  
If set ON 4hr, OFF 5hr, the sequence will be ON -> OFF. Means, ON after 4hrs, OFF after 1hr ON.  
If set ON 7hr, OFF 3hr, the sequence will be ON <- OFF. Means, OFF after 3hrs, ON after off 4hrs.

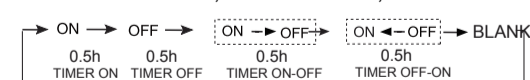

Health airflow Operation

- Press [Power] to starting Setting the comfort work conditions
- The setting of healthy airflow function  
Press button to select "Healthy airflow", the remote controller will switch as below

Notice: Do not direct the flap by hand. Otherwise, the grille will run incorrectly. If the grille is not run correctly, stop for a minute and then start, adjusting by remote controller.  
Note:  
1. After setting the healthy airflow function, the position grill is fixed.  
2. In cooling, it is better to select the [Auto] mode.  
3. In cooling and dry, using the air conditioner for a long time under the high air humidity, condensate water may occur at the grille.